

shristinagar  
Guwahati

SHRISTI  
WELCOME TO LIFE



# Lake Chalet





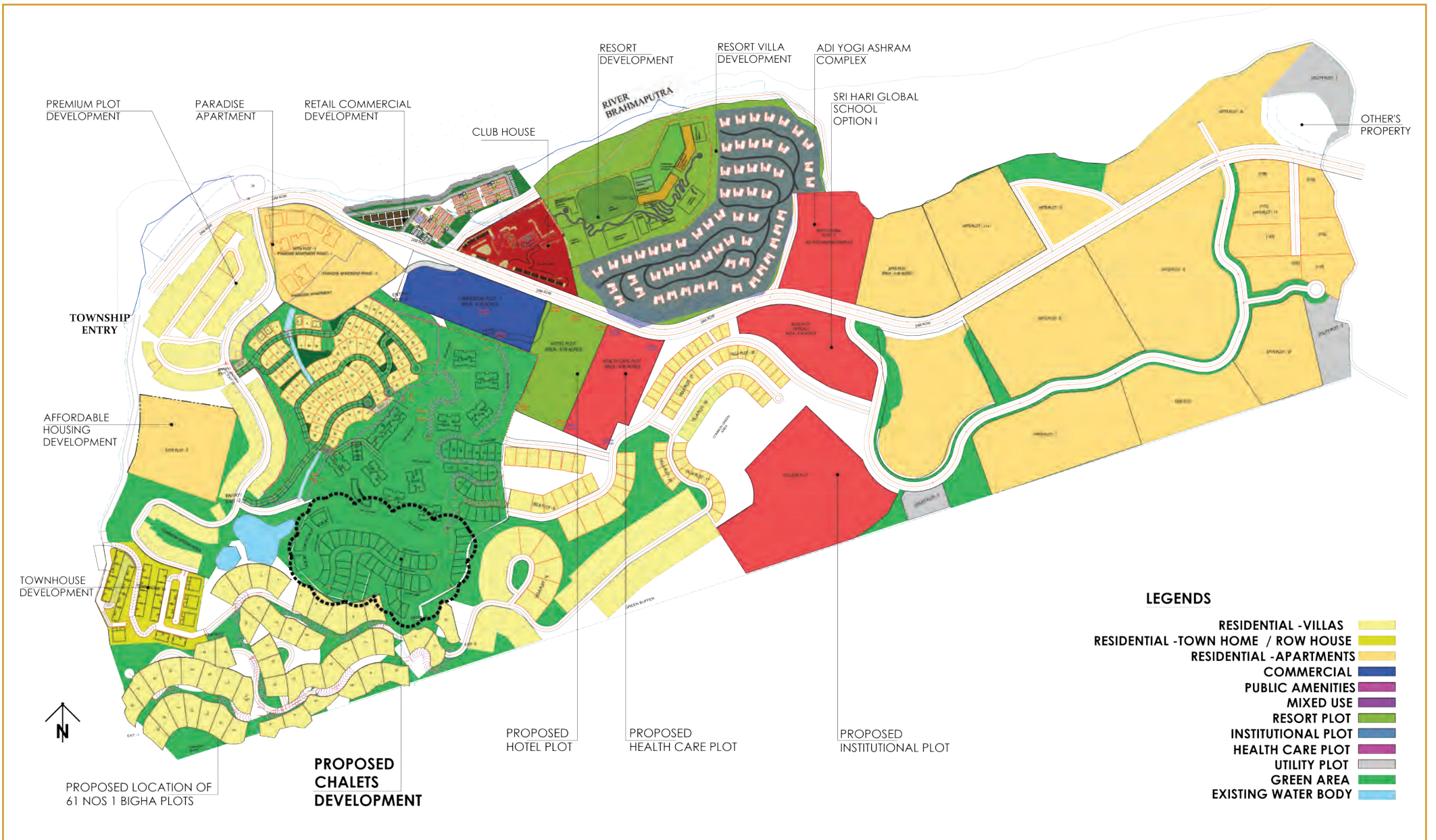

**LEGENDS**

- RESIDENTIAL - VILLAS
- RESIDENTIAL - TOWN HOME / ROW HOUSE
- RESIDENTIAL - APARTMENTS
- COMMERCIAL
- PUBLIC AMENITIES
- MIXED USE
- RESORT PLOT
- INSTITUTIONAL PLOT
- HEALTH CARE PLOT
- UTILITY PLOT
- GREEN AREA
- EXISTING WATER BODY

# Master Plan





# Site Plan

A stylized landscape illustration featuring rolling hills in shades of green and blue, a yellow mountain peak on the left, and various green trees. The scene is framed by a thin orange border, with leafy branches extending from the top-left and bottom-right corners.

# *Uphill Chalet*

(G+2)



shristinagar  
Guwahati

SHRISTI  
WELCOME TO LIFE

Breathtaking views of the lake





shristinagar  
Guwahati

Drive through winding roads to your quaint home

SHRISTI  
WELCOME TO LIFE





shristinagar  
Guwahati

Independent bungalows with car parking

SHRISTI  
WELCOME TO LIFE







UP HILL- LEV 00 - 516 SQ.FT.



UP HILL- LEV 01 - 1046 SQ.FT.



UP HILL- LEV 02 - 991 SQ.FT.

Deck / Balcony Area = 175 SQ.FT.  
(Covered)



A stylized, layered illustration of a mountain landscape. The background features rolling hills in shades of light blue and green. In the foreground, there are darker green and blue mountain peaks, some with small evergreen trees. The overall style is soft and artistic, with a focus on natural elements. A thin gold border frames the entire scene.

# *Downhill Chalet*

(G-2)



shristinagar  
Guwahati

Serene and peaceful ambience

SHRISTI  
WELCOME TO LIFE





shristinagar  
Guwahati

Everyday feels like a luxury vacation

SHRISTI  
WELCOME TO LIFE





Lake-facing Chalets amidst greenery



Top view of the Chalets







Deck / Balcony Area = 435 SQ.FT.  
(Covered)





Internal view

## SPECIFICATIONS

<b>Living &amp; Dining Room</b>	Vitrified Tiles
<b>Bedrooms</b>	Vitrified Tiles
<b>Internal staircase</b>	Marble with SS railings
<b>Kitchen</b>	
Floor	Anti-skid ceramic tiles
Dado	Glazed ceramic tiles upto 2ft height above kitchen counter
Counter	Granite of required shade 600 mm wide
Sink	Stainless sink with drainboard
<b>Toilet</b>	
Floor	Anti-skid ceramic tiles
Dado	Glazed ceramic tiles upto lintel level on all sides
S&P fixtures	European type
Wash basin	Ceramic with bottle trap
Hardware Fittings	C.P. fittings of Jaquar or equivalent Provision of geyser point (without geyser) in all the toilets. Provision for hot & cold water mixer arrangement in shower and wash basin.
<b>Door</b>	Main Door- Standard wood frame with veneer/ laminated finished paneled door. Other doors- painted flush doors.
<b>Window</b>	UPVC / aluminium anodized sliding windows
<b>Electricals</b>	Concealed wiring with PVC conduits and modular switches of reputed brand. AC Point in all bedrooms and living dining rooms with starter of reputed brands. Provision for TV and telephone connections.
<b>Interior design</b>	Modular kitchen (If client wants at an additional cost)
<b>Landscaping</b>	Design for soft and hard landscaping according to the plot topography
<b>Rain water harvesting</b>	Design for collection, storage and using rainwater for landscaping/purposes



## Location map







**Shristinagar Guwahati Private Limited**

**CORPORATE OFFICE**

Plot No. X - 1, 2 & 3, Block EP, Sector - V,  
Salt Lake City, Kolkata - 700 091,  
Phone: +91 33 4020 2020  
Fax: +91 33 4020 2099

**REGISTERED OFFICE**

Ramsai Hills, Choonsali, Near Sector 1 ( IOCL),  
Noonmati, Guwahati 781020  
Phone: +91 7399000222 / 7399000111 / 7002091743  
RERAA KM 228 of 2024 - 2025

**e-mail: [contact@shristicorp.com](mailto:contact@shristicorp.com) | [www.shristiguwahati.com](http://www.shristiguwahati.com)**

Disclaimer- This brochure is purely conceptual. Visual representations are not to be taken as representations of fact, and do not form part of an offer or contract. The management of Shristinagar Guwahati Private Limited reserves the right to add, delete or alter any specifications / plan mentioned here without prior notice.